

H. O. CO. ACREAGE 640 SUB NO. B.B.B. & C. Ry. Sec. 5 SURVEY Tyler COUNTY, ABSTRACT NO. 143

Acreage found 640 Patentee \_\_\_\_\_ Estimated by C. P. Dumphy Date October 27, 1910  
 Timber Rights Expire \_\_\_\_\_ Mineral Rights Expire \_\_\_\_\_ H. O. Co. Represented by \_\_\_\_\_  
 Encroachments, Conflict, Trespass, Houses, Fences, Fields None  
 Has Land Been Cut Over? Yes When 5 yrs. By Kirby Lumber Co. Class of Timber Cut Long Leaf Pine  
 Topography Rolling Soil Sand  
 Adaptable for Grazing and Agriculture Indications of \_\_\_\_\_

**PINE REPRODUCTION**

Area No.	A	B		
Acres	615	25		
L. L. Seedlings				
S. L. Seedlings				
L. L. 7"	103M			
L. L. 8" to 11"	367M			
S. L. 7"				
S. L. 8" to 11"		2M		
Total Feet	470M	2M		

**MERCHANTABLE PINE (M. FEET) HERRING LOG SCALE—OUTSIDE BARK MEASUREMENT**

AREA NO.	ACRES	LONG LEAF		SHORT LEAF		LOGS TO TREE	LOGS TO M.	TOTAL FEET
		12" to 16"	17" & Up	12" to 16"	17" & Up			
A	615	1274	1817			3½	10	3,091,000
B	25			18	72	4	7	90,000
Total Feet								3,181,000

Growth Vigorous Quality Small timber sound and smooth, large timber defective  
 Isolated or Grouped Scattered Injury \_\_\_\_\_  
 Jeopardized by \_\_\_\_\_ Preferred Method of Logging Teams

**HARDWOOD (M. FEET) SCRIBNER-DOYLE LOG SCALE—INSIDE BARK MEASUREMENT**

Method of Logging	AREA NO.	ACRES	TUPELO GUM	RED GUM		CYPRESS		WHITE OAK		RED OAK		HICK-ORY	ASH	BEECH	MAG-NOLIA	TOTAL		
				Ties	Feet	Ties	Feet	Ties	Feet	Ties	Feet					Feet	Ties	
Nearest Stream	B	25						100	10	50	5						15,000	150
Reproduction <u>None</u>																		
Quality fair																		

Revised Courses and Distances

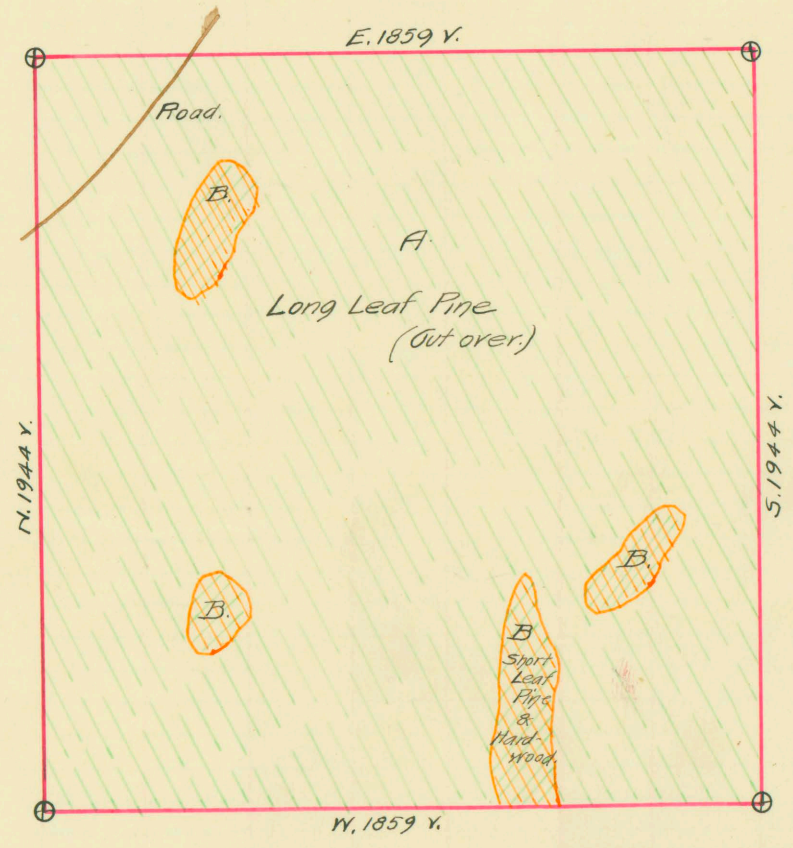



*In vault*

ABSTRACT NO. 143

# RECORD OF TIMBER CUTTING

DATE	PINE						HARDWOOD												
	LONG LEAF		SHORT LEAF		TIES	PILING	TUPELO GUM	RED GUM		CYPRESS		WHITE OAK		RED OAK		HICKORY	ASH	BEECH	MAGNOLIA
	12" to 16"	17" Up	12" to 16"	17" Up				Ties	Feet	Ties	Feet	Ties	Feet	Ties	Feet				
1912 Jan	✓	321329	Camp 1																
Feb	✓	1093747																	
Mar	✓	211236																	
May	✓	113851																	
June	✓	90621																	
July	✓	8907																	
		✓ 1839691																	

*Inspector W. O. Bantjes from Sal. 6 #175-12/19/12 reports this survey showed of merchantable pine except 10,000 feet in defective trees*

*Field under heading Camp 1*